

Osaki

OS- Tao 3D
MASSAGE CHAIR
OPERATION INSTRUCTIONS

SAVE THESE INSTRUCTIONS

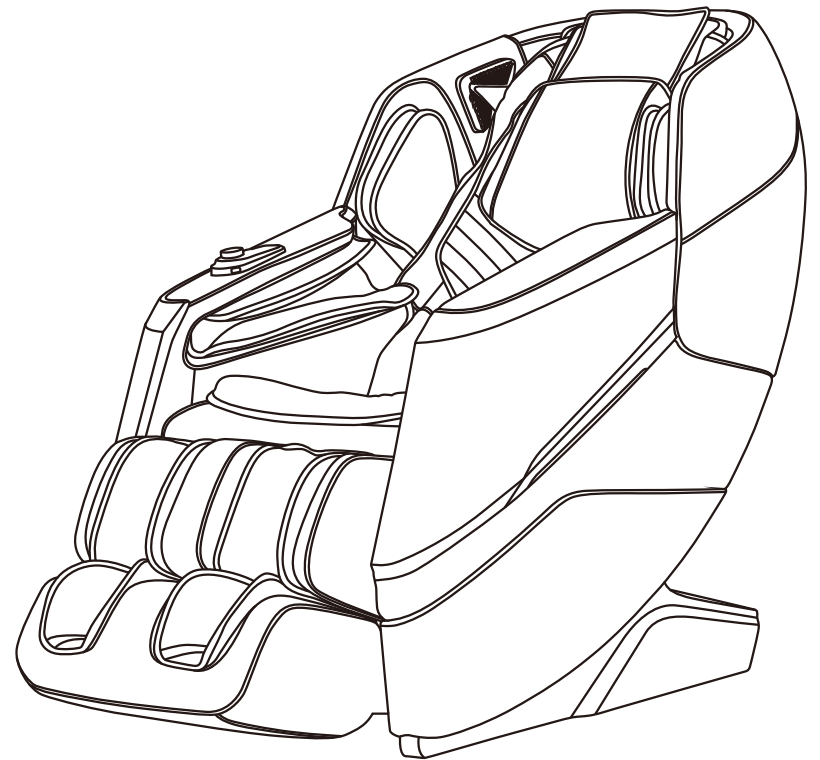

Thank You for purchasing this product. Please read this manual instruction carefully in order to know how to use this product correctly before operation. Please pay more attention to the important safety warnings and keep this manual book properly for future use.

Note: We reserve the right to change the design and manual of the product. Details are subject to change over time, and will not be informed otherwise. If there are some differences between the products in the market circulation and the description in the manual, it is a normal update of the product. Specific product functions and colors are subject to change at any time.

TABLE OF CONTENTS

Important Safety Instruction	02-03
Instructions De Securite Importantes	04-05
Safety Warning	06-08
Name of Components	09
Function	10-11
Introduction to the Remote Controller	12-13
Method of Usage	14-39
I.Turn on the power supply of this product	14
II.Massage function control operation	14-32
III.Introduction to armrest shortcut keys	33-34
IV.Voice control mode	35
V.Turn off the power and stop massage	36
VI.Operation Instructions for Bluetooth Speaker Play	36
VII.Installation Instructions for Legrest	37
VIII.Instructions for removal and use of head cushion and backrest	38
IX.Floor Protection	38
X.Instruction for movement	39
Product Specification	40

Important Safety Instruction

When using an electrical appliance, basic precautions should always be followed, including the following:

Read all instructions before using (this appliance)

DANGER-To reduce the risk of electric shock:

1) Always unplug this appliance from the electrical outlet immediately after using and before cleaning.

WARNING-To reduce the risk of burns, fire, electric shock, or injury to Persons:

- 1) An appliance should never be left unattended when plugged in. Unplug from outlet when not in use, and before putting on or taking off parts.
- 2) Do not operate under blanket or pillow. Excessive heating can occur and Cause fire, electric shock, or injury to persons.
- 3) Close supervision is necessary when this appliance is used by, on, or near children, invalids, or disabled persons.
- 4) Use the appliance only for its intended use as described in this manual. Do not use attachments not recommended by the manufacturer.
- 5) Never operate this appliance if it has a damaged cord or plug, if it is not working properly, if it has been dropped or damaged, or dropped into water. Return the appliance to a service center for examination and repair.
- 6) Do not carry this appliance by supply cord or use cord as a handle.
- 7) Keep the cord away from heated surfaces.
- 8) Never operate the appliance with the air openings blocked. Keep the air openings free of lint, hair, and the like.
- 9) Never drop or insert any object into any opening.
- 10) Do not use outdoors.
- 11) Do not operate where aerosol (spray) products are being used or where oxygen is being administered.
- 12) To disconnect, turn all controls to the off position, then remove plug from outlet.
- 13) The appliance is intended for household and indoor use only.

Important Safety Instruction

- 14) Connect this appliance to a properly grounded outlet only ,see grounding instructions .
- 15)Keep children away from extended foot support (or other similar parts
- 16)Do not use massager in close proximity to loose clothing or jewelry.
- 17)Keep long hair away from massager while in use.
- 18)Connect this appliance to properly grounded outlet only. See Grounding Instructions.

SAVE THESE INSTRUCTIONS

GROUNDING INSTRUCTIONS

This product must be grounded, if it should malfunction or breakdown, grounding provides a path of least resistance for electric current to reduce the risk of electric shock, this product is equipped with a cord having an equipment grounding conductor and a grounding plug, the plug must be plugged into an appropriate outlet that is properly installed and grounded in accordance with all local codes and ordinances.

DANGER: Improper connection of the equipment grounding conductor can result in a risk of electric shock, check with a qualified electrician or serviceman of you are in doubt as to whether the product is properly grounded, do not modify the plug provided with the product-if it will not fit the outlet, have a proper outlet installed by a qualified electrician.

1)This product is for use on nominal 120-volt circuit, and has a grounding plug that looks like the plug illustrated in sketch on the page 39, A temporary adapter that looks like the adapter illustrated in sketches B and C may be used to connect this plug to a 2-pole receptacle as shown in sketch B if a properly grounded outlet is not available the temporary adapter should be used only until a properly grounded outlet (shetch A)can be installed by a qualified electrician, the green colored rigid ear, lug, or the like extending from the adapter must be connected to a permanent ground such as a properly grounded outlet box cover, Whenever the adapter is used, it must be held in place by a metal screw.

Instructions De Securite Importantes

lors de l'utilisation d'un appareil électrique, des précautions de bases doivent être respectées, y compris ce qui suit :

Lisez toutes les instructions avant d'utiliser l'appareil.

DANGER- Pour réduire le risque de choc électrique:

- 1) Toujours débrancher cet appareil de la prise électrique immédiatement après usage et avant nettoyage

AVERTISSEMENT- Pour réduire le risque de brûlures, d'incendie, de choc électrique ou de blessures:

- 1) Cet appareil ne doit jamais quitter votre surveillance lorsqu'il est branché. Débranchez-le de la prise lorsqu'il est inutilisé, et avant de placer ou d'enlever des pièces.
- 2) Ne pas utiliser cet appareil sous une couverture ou un oreiller. Une chaleur excessive peut provoquer un incendie, un choc électrique ou des blessures corporelles.
- 3) Soyez prudent et maintenez une surveillance accrue lorsque cet appareil est utilisé par, sur, ou près des enfants, de personnes invalides ou handicapées.
- 4) Utilisez l'appareil uniquement pour un usage habituel, comme décrit dans ce manuel. Ne pas utiliser d'accessoires non recommandés par le fabricant.
- 5) Ne jamais faire fonctionner cet appareil si le cordon ou la fiche sont endommagés, s'il ne fonctionne pas correctement, s'il est endommagé ou s'il est tombé dans l'eau. Retournez l'appareil au service technique pour examen et réparation.
- 6) Ne transportez pas cet appareil par le cordon d'alimentation ou d'utilisation comme une poignée.
- 7) Gardez le cordon loin des surfaces chauffées.
- 8) Ne jamais faire fonctionner l'appareil en obstruant les ouvertures d'air. Gardez les ouvertures à l'air, libre de peluches, de cheveux, etc.
- 9) Ne jamais laisser tomber, ou insérer d'objet dans les ouvertures.
- 10) Ne pas utiliser à l'extérieur.
- 11) Ne pas utiliser dans les lieux où des aérosols (vaporisateurs) sont utilisés, ni là où l'oxygène est administré.
- 12) Pour débrancher, mettre tous les boutons de l'appareil sur la position arrêt, puis retirer la fiche de la prise.
- 13) L'appareil est destiné à un usage domestique et à l'intérieur seulement.
- 14) Connectez cet appareil à une prise correctement reliée à la terre. Voir les instructions de mise à la terre.

Instructions De Securite Importantes

15) Éloignez les enfants du support de pied ouvert (ou des autres pièces semblables).

16) Ne pas utiliser de massage à proximité des vêtements amples ou des bijoux.

17) Garder les cheveux longs à l'écart de masseur en cours d'utilisation.

18) Raccordez cet appareil à une prise correctement mise à la terre.

CONSERVER CES INSTRUCTIONS INSTRUCTIONS DE BASES

Ce produit doit être relié à la terre. Si il dysfonctionne ou tombe en panne, la terre fournit un chemin de moindre résistance pour le courant électrique afin de réduire le risque de choc électrique. Cet appareil est équipé d'un cordon avec un conducteur de mise à la terre des équipements et une prise de terre. La fiche doit être branchée dans une prise appropriée qui est correctement installée et mise à la terre conformément à la réglementation locale.

DANGER: un mauvais branchement de l'équipement à la prise de terre, peut entraîner un risque de choc électrique. Consultez un électricien qualifié si vous avez des doutes quant à savoir si le produit est correctement mis à la terre. Ne pas modifier la fiche fournie avec le produit si elle ne rentre pas dans la prise. Adressez vous à un électricien qualifié le cas échéant.

1) Ce produit est destiné à être utilisé sur un circuit de 120 volts, et possède une fiche de mise à la terre semblable à la fiche illustrée sur le croquis de la page 39. Un adaptateur temporaire qui ressemble à l'adaptateur illustré sur le croquis B et C peut être utilisé pour brancher cette fiche à un réceptacle 2-pole, comme indiqué sur le croquis B. Si une prise de terre n'est pas disponible, l'adaptateur temporaire ne doit être utilisé que jusqu'à une prise de terre correcte (croquis A) pour être installé par un électricien qualifié. L'oreille rigide de couleur verte, qui dépasse de l'adaptateur, doit être connectée à une terre permanente comme un couvercle de boîte de sortie mise à la terre. Chaque fois que l'adaptateur est utilisé, il doit être maintenu en place par une vis en métal.

**S'il vous plaît noter que lorsque ne pas coincer votre détection des doigts
Avant le nettoyage ou la réparation doivent couper l'alimentation**

Safety Warning

⚠ Warning

When the legrest of the massage chair is lifted, nobody should apply pressure on the legrest to prevent the massage chair from falling forward which will damage this product or result in personal injuries.

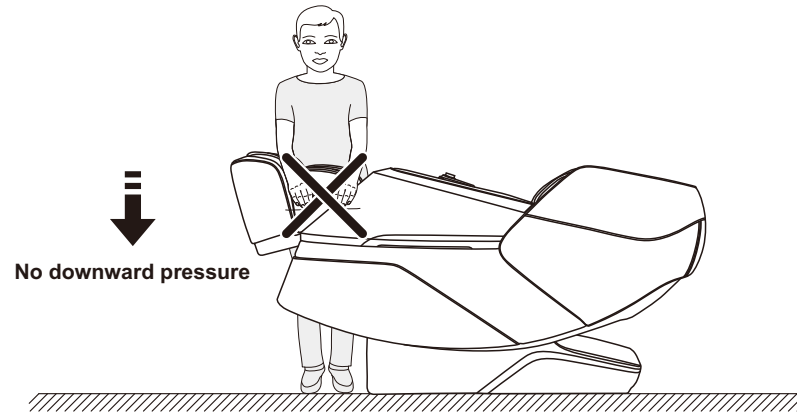

⚠ Warning

Before sitting on the massage chair, make sure that the massage chair manipulator does not stay in the seat cushion position to avoid discomfort to the buttocks during the body pressing down and any damage to the massage chair manipulator.

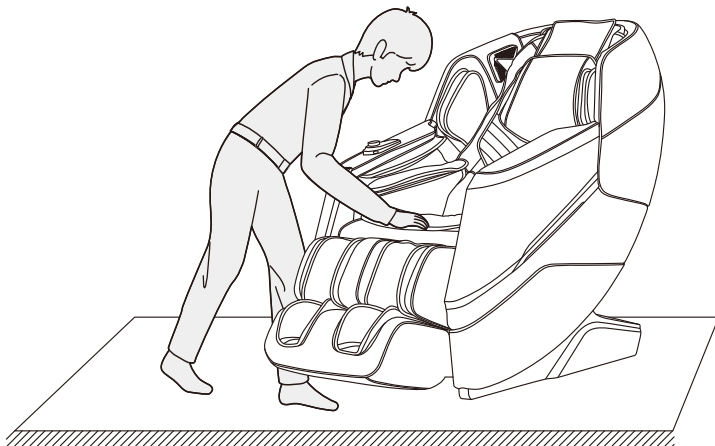

06

Safety Warning

⚠ Warning

Do not remove or pull out the remote controller cable or the power cord in the standby or power-on state to avoid any damage to this product or accidental electric shock of a body part. You are advised to unplug the remote controller cable and the power cord and put them away after you use the massage chair.

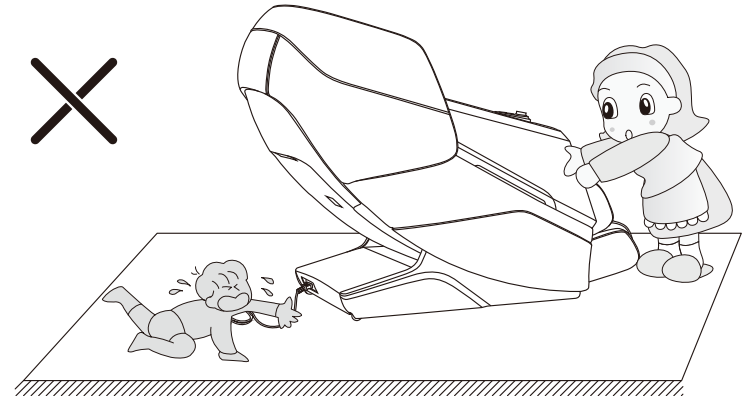

⚠ Warning

When the zero-gravity lying function is enabled, be sure to check whether there is any child or pet staying or playing under the bottom of the legrest and backrest, in order to avoid any damage to this product or physical injury.

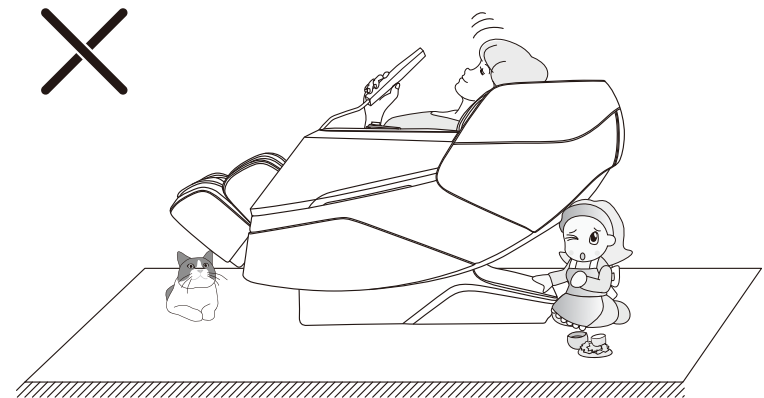

07

Safety Warning

Warning

Before using the massage chair, remove any hard objects in your pocket(s) or any jewelry carried with you (e.g. key, watch, other similar portable hard objects) to avoid any damage to this product or physical injury during massage.

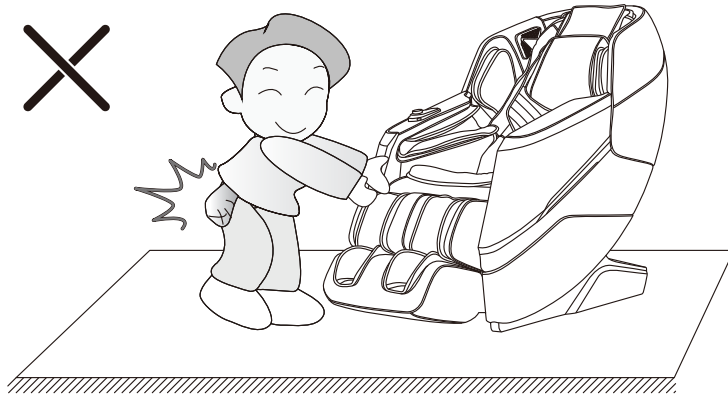

Warning

Do not unplug the power cord, or directly turn off the power switch on the back of the massage chair during massage, in order to avoid any damage to this product or physical injury.

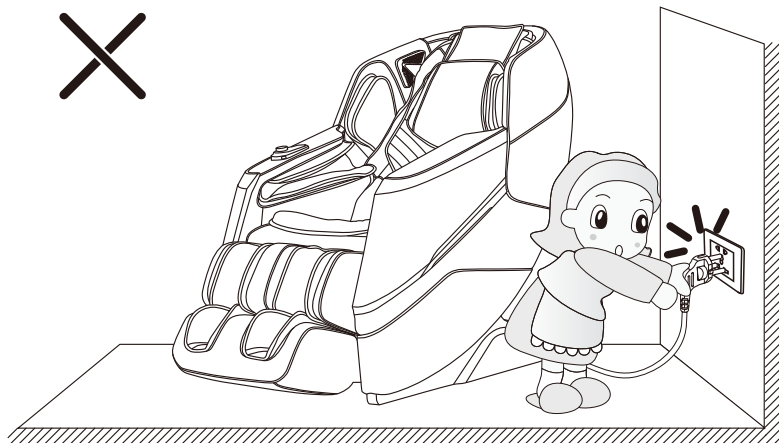

Name of Components

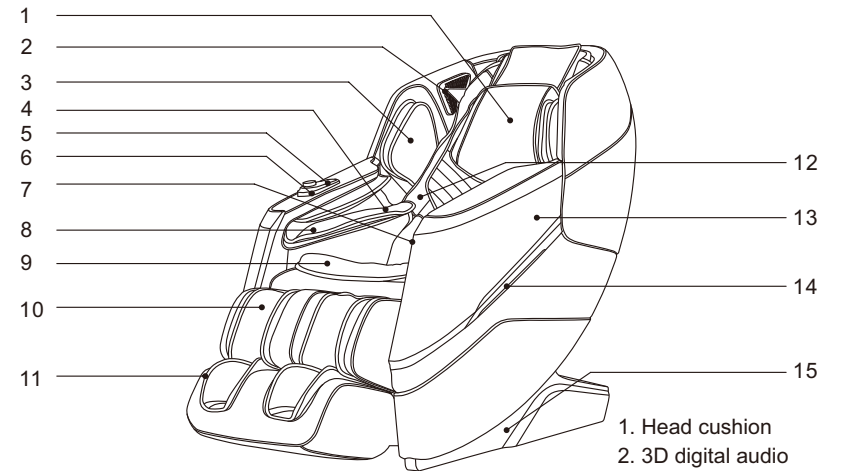

1. Head cushion
2. 3D digital audio (voice control install in right speaker)
3. Upper arm airbag component
4. Armrest airbag component
5. Short cut button
6. USB charging socket
7. Mobile phone placement slot
8. Salient massage hand with magnetic therapy
9. Seat cushion
10. Leg rest
11. Foot rest
12. Backrest
13. Armrest
14. LED atmosphere lamp
15. Side cover

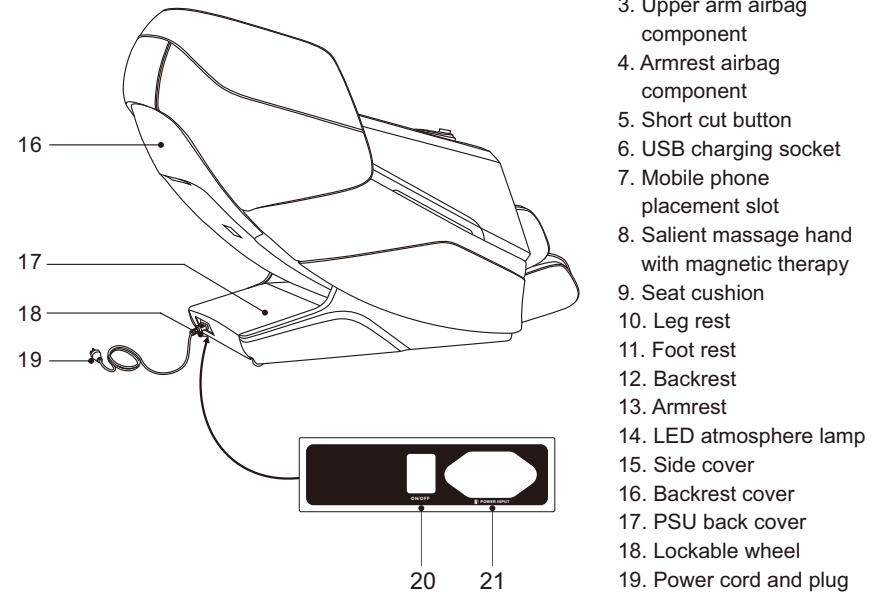

16. Backrest cover
17. PSU back cover
18. Lockable wheel
19. Power cord and plug
20. Switch
21. Mains input

Function

- This product has designed a set of 3D air suspension massage hands which can move up and down as well as stretch back and forth.
- The design has the function of automatic detection and micro-adjustment of shoulder position: according to the detected human body curve, the front and back expansion and contraction of the massage hand can be automatically adjusted, which makes massage more humanized and scientific.
- With characteristic automatic massage functions: Comfort massage, Relaxing massage, Stretch Massage, Neck&shoulder Massage, Back&Waist Massage, Full body Massage, Ancient Beauty Care, Leg&hip Care, Release Sedentary Stress, Spine Care, President Cosy, Relieve Soreness, Good-night Sleep, Sport Recovery, Meridian Treatment. and other 15 automatic massage functions.
- There are three intelligent storage functions: Memory I, Memory II and Memory III.
- Manual massage range selection with massage hand: including fixed-point, local, upper back, lower back and full back.
- Manual massage function: including kneading, flapping, kneading and flapping, shiatsu, tapping, 3D (3D I, 3D II) and other seven massage techniques.
- It is equipped with massage adjustment function: including 3D intensity adjustment in 3 gears, air pressure intensity adjustment in 3 gears and time adjustment in 4 gears.
- Equipped with upper body air massage function: upper arm air massage function (built-in 4 airbags), arm air massage function (built-in 4 airbags), palm air massage function (built-in 4 airbags), and third-gear air intensity adjustment.
- With lower body air pressure massage function: calf air pressure massage function (built-in 12 airbags), three-gear air pressure intensity adjustment.
- The guide rail of backrest frame adopts curved guide rail technology, which completely fits the back curve of human body, and can enjoy close-fitting massage from head to thigh.
- With intelligent voice recognition function.
- There are bump massage and magnetic therapy functions in the left and right palm airbags.
- Equipped with back heating and leg heating functions: adopt far infrared heat source.
- Music playing system with 3D digital audio built in left and right upper arms. The Bluetooth function of smart devices can be used for wireless connection to play music.
- With leg stretch massage function: use the lower leg and backrest to lift and form automatic lying, and automatically circulate lying. At the same time, the lower leg air pressure, the back massage hand cooperate with massage at the same time, and the legs are stretched and towed for massage.

Function

- It is equipped with independent lifting adjustment function of calf frame, linkage lifting adjustment function of backrest frame and automatic lying angle adjustment function of zero gravity.
- The right armrest is provided with handrail shortcut keys such as power on/off key, linkage adjustment key, pause key, automatic mode key, voice control wake-up key, heating key, air pressure key, calf rest up key, calf rest down key, zero gravity key, backrest frame up key and backrest frame down key.
- With foot roller massage function, a group of rollers rolling scraping massage on soles of feet, and the speed is adjustable in three gears.
- The calf is equipped with telescopic adjustment function, pedaled out your foot to extension. The extension length of the foot can be determined according to the length of the user's leg, and the foot retracts by spring force; Suitable for different people's heights.
- USB charging function is provided on the side of shortcut key at the front end of right armrest.
- LED ambience lights are provided on armrests on both sides.
- Automatic sit-up function after turn off the chair and automatic reset function of massage hand.
- With TFT color screen manual controller.

Introduction to the Remote Controller

Display screen section of manual controller

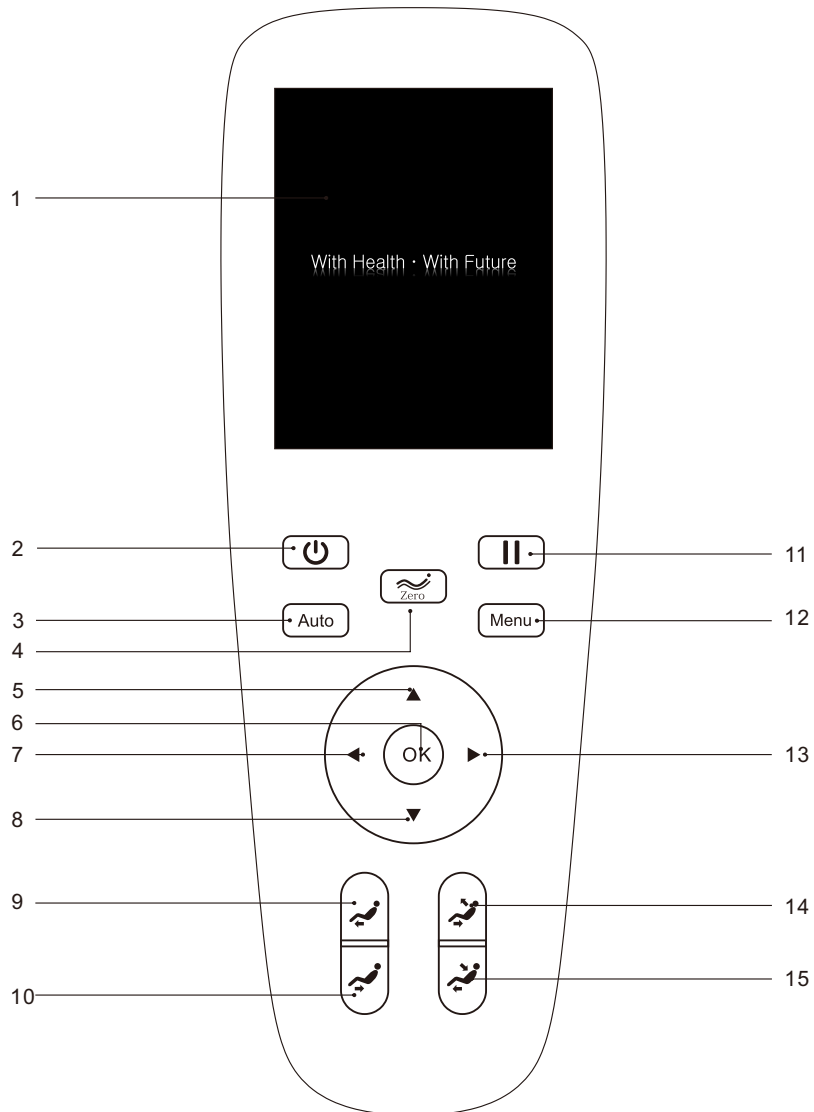

Introduction to the Remote Controller

1. Display screen:
 - TFT color liquid crystal display screen displays the massage function in the running state.
2. On/off key:
 - Turn on or off the massage chair.
3. Automatic key:
 - Enter the automatic function mode selection interface. Please refer to page 15 of this manual for detailed function description.
4. Zero-gravity key:
 - Adjust the zero-gravity angle of the massage chair, and there are four modes for selection (pressing for the first time enters the first gear, pressing for the second time enters the second gear, pressing for the third time enters the third gear, and pressing for the fourth time restores to the initial state).
5. Up key:
 - Navigate the Up key, select the object upward in the menu, or adjust the massage position upward.
6. OK key:
 - Confirm the selected massage function to perform confirmed massage.
7. Left key:
 - Navigate the Left key, return to the previous menu, or select the object to the left.
8. Down key:
 - Navigate the Down key, select the object downward in the menu, or adjust the massage position downward.
9. Lower leg frame ascending key:
 - According to the user's own massage requirement, the lower leg frame is ascended to the most comfortable massage posture.
10. Lower leg frame descending key:
 - According to the user's own massage requirement, the lower leg frame is descended to the most comfortable massage posture.
11. Pause key:
 - Pause all currently running massage functions, and press this key again to continue running all massage functions before the pause.
12. Menu key:
 - Enter the main menu selection interface. Please refer to page 15 of this manual for detailed function descriptions
13. Right key:
 - Navigate the Right key to enter the sub-menu, or select the object to the right.
14. Linkage sit-up key:
 - According to the desired massage angle, the backrest frame and the lower leg frame are adjusted for linkage sit-up at the same time to the most comfortable linkage sit-up massage posture.
15. Linkage lying key:
 - According to the desired massage angle, the backrest frame and the lower leg frame are adjusted for linkage lying at the same time to the most comfortable linkage lying massage posture.

Method of Usage

I. Turn on the power supply of this product:

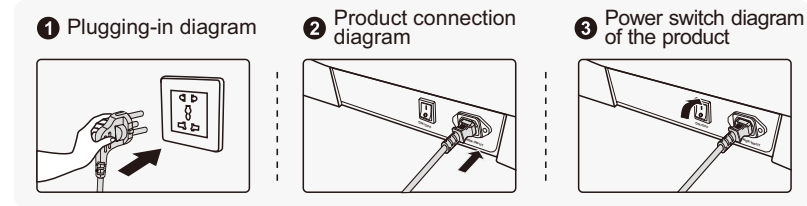

II. Massage Function Control Operation:

1. Standby

- When the massage chair power cord connected, and the chair in standby state, you can turn on the chair by power on/off key, rise up and lying down the chair, and use the voice control wake up key.

2. Start massage (on/off key)

- Press the on/off key to start the massage, and the backrest frame and lower leg frame will automatically lie down to the set angle.
- After lying in place automatically, the massage chair automatically detects the shoulder position and body shape waiting for the detection to be completed. Or press the "OK" key to directly skip the shoulder position and body shape detection, then turn on the default value to start massage.

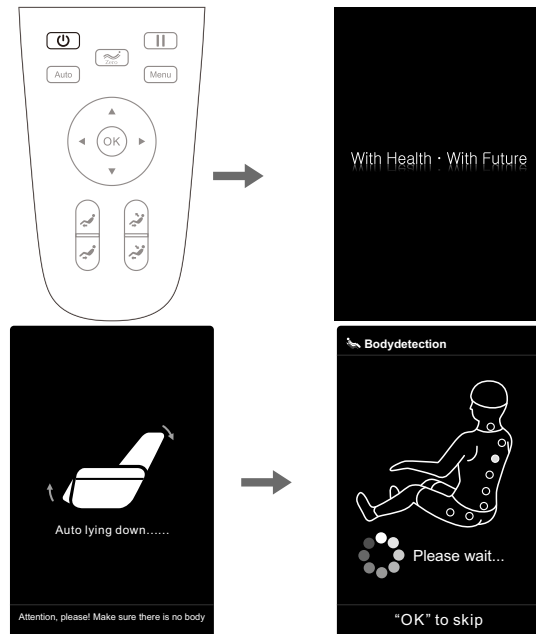

Method of Usage

1). Shoulder position adjustment

- After detecting the shoulder position, the buzzer prompts with a "beep." If there is any difference from the actual shoulder position, adjust to the appropriate position by pressing "Up" or "Down." Shoulder position is adjustable in 11 gears. If there is no shoulder position adjustment within 10 seconds, it will automatically enter the massage function. If you press the "OK" key directly, you will enter the massage immediately. If the shoulder position cannot be detected, massage is performed at the default shoulder position height.

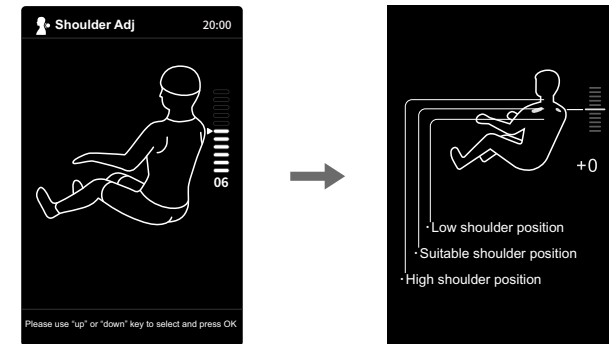

Button	Description
	Move the massage balls upward to a suitable shoulder position
	Move the massage balls downward to a suitable shoulder position

- After entering the massage program, if it is necessary to adjust the shoulder, from the operation status information interface, you can directly select the shoulder adjustment button to enter the whole shoulder adjustment interface, and adjust the shoulder position and height through the "Up" or "Down" key; press the "Left" key to return to the previous menu interface.

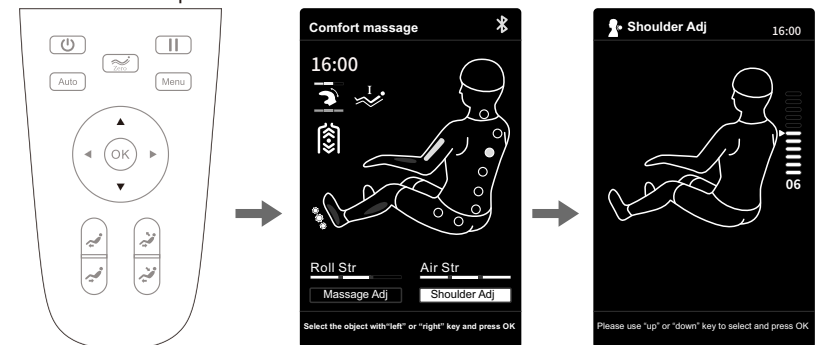

Method of Usage

2).Message position adjustment

- After entering the message program, if it is necessary to adjust the message position, press the "Menu" key on the manual controller to select the manual program to enter, select the manual program, and then press the "Left" key to return to the information interface (the information interface is changed to the manual program interface).
- From the manual program interface, if the message position displays fixed points or local, you can directly press the "Up" or "Down" key to move the manipulator up and down.
- From the manual program interface, if the message position is not fixed point or local, you need to select message adjustment to enter, then select the message part, select fixed point or local, then press the "Left" key to return to the information interface, and then press the "Up" or "Down" key to move and adjust the manipulator up and down.

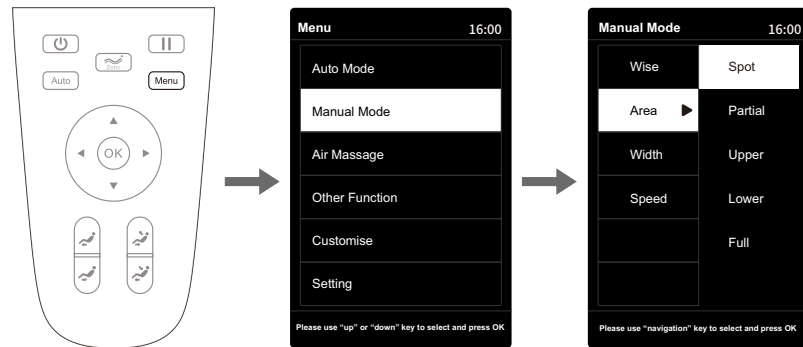

Note: In auto mode, the manipulator cannot be moved up and down through the "up key" or "down key".

3.Pause key

- When the massage function is running, press the "Pause" key to temporarily stop all massage functions; press the "Pause" key again to continue the massage function before the pause. If the pause lasts for more than 20 minutes, all massage functions will be automatically turned off.

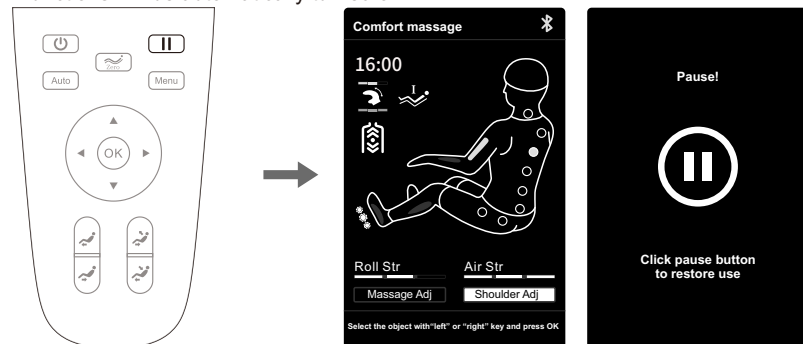

Method of Usage

4.Menu key

- Press the "Menu" key to enter the menu message function selection interface, including automatic program, manual program, air compression massage, auxiliary function, memory storage, setting function, etc.
- After entering the menu interface, press the "Up" or "Down" key to select the desired message function, select any function, and then press the "OK" key to confirm. Press the "Left" key to return to the previous menu interface.

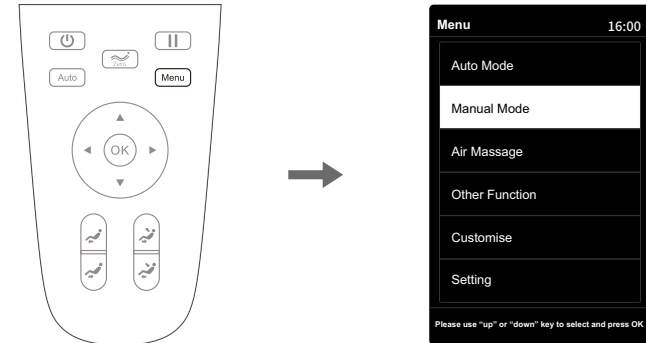

1).Automatic program (menu - automatic program, or you can also enter the automatic program interface through the "Automatic" key)

- Press the "Menu" key to enter the menu interface, press the "Up" or "Down" key to select the automatic function, and press the "OK" key (or directly press the "Automatic" key in the information interface) to enter the selection of the automatic function.
- Automatic functions include 15 automatic massage modes, i.e. Comfort massage, Relaxing massage, Stretch Massage, Neck&shoulder Massage, Back&Waist Massage, Full body Massage, Ancient Beauty Care, Leg&hip Care, Release Sedentary Stress, Spine Care, President Cosy, Relieve Soreness, Good-night Sleep, Sport Recovery and Meridian Treatment .
- Enter the automatic function interface, press the "Up" or "Down" key to select any automatic function massage program, and then press the "OK" key to confirm. It will automatically return to the information interface, and the information interface will be displayed as an information interface with automatic functions.

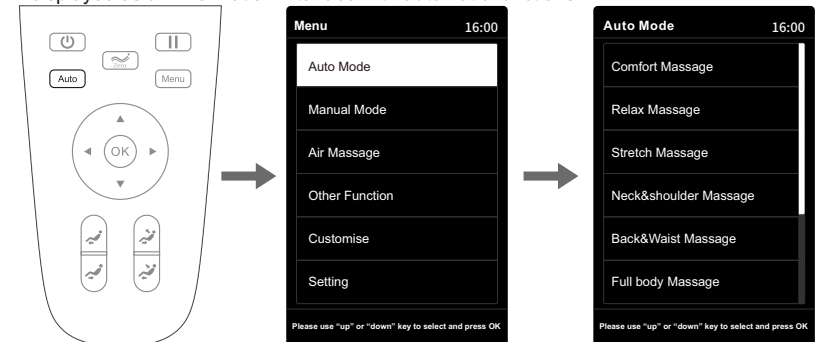

Method of Usage

Function	Description
Comfort Massage	The most comfortable massage experience.
Relax Massage	Gentle and comfortable deep massage, which can relieve body fatigue and relax the body.
Stretch Massage	The lower leg frame and the backrest frame are lifted and lowered for stretching and traction of the leg and waist, effectively relieving tiredness, relieving joint soreness and restoring vitality.
Neck&shoulder Massage	According to the unique neck and shoulder massage method, through effective massage of cervical spine and scapula, neck and shoulder pain can be relieved and neck and shoulder fatigue can be improved.
Back&Waist Massage	Focus on the back and waist to relieve back and waist soreness.
Full body massage	Deep massage, which can revive body vitality.
Ancient Beauty Care	Massage manipulator combine with shoulder airbags, kneading massage focus on neck and shoulder, kneading and tapping massage on back and waist, kneading massage on buttocks, kneading and tapping massage on laps, foot rollers, legs airbags and arm airbags massage started at same time.
Leg& hip Care	The foot roller function started, air bags inflate and deflate, and the massage manipulator move from legs to buttock with kneading and flapping massage technique.
Release Sedentary Stress	Aim to office sedentary group, increase the amount of physical exercise by massage, improve the body function.
Spine Care	Protect the health of the whole spine, and improve the lack of exercise.
President Cosy	The massage manipulator, combine with airbags, rollers and the music played by bluetooth connecting, relax the physical and mental pressure of business groups.
Relieve Soreness	Soothe fatigue and pain on the human body, relax the limbs and improve micro-circulation, relieve joint pain and restore vitality.

Method of Usage

Good-night Sleep	With kneading, shiatsu massage techniques, combined with low-intensity air pressure massage and function, through the 12 health acupoints massage, help to regulate and balance on human body;At the same time, the massage chair automatically swings back and forth to form a zero-gravity cradle massage state, so that people can fall asleep more quickly, improve sleep quality.
Sport Recovery	By pressing and rubbing with the air bag and rolling with the wheel, it can relieve the swelling of the shoulders, arms, knees, calves and other key parts after exercise, and quickly recover the fatigue after exercise.
Meridian Treatment	Dredge the channels and collaterals, quickly improve the body's micro-circulation, and enhance immunity.

2).Manual program (menu - manual program)

- Press the "Menu" key to enter the menu interface, press the "Up" or "Down" key to select the manual program, and press the "OK" key to enter the manual function interface.
- Manual program: including method, position, width, speed and other massage functions.
- After entering the manual program interface, press the "Up" or "Down" key to select any manual program, then select the function sub-menu using the "Right" key, and then press the "OK" key to confirm. Press the "Left" key to return to the previous menu interface.

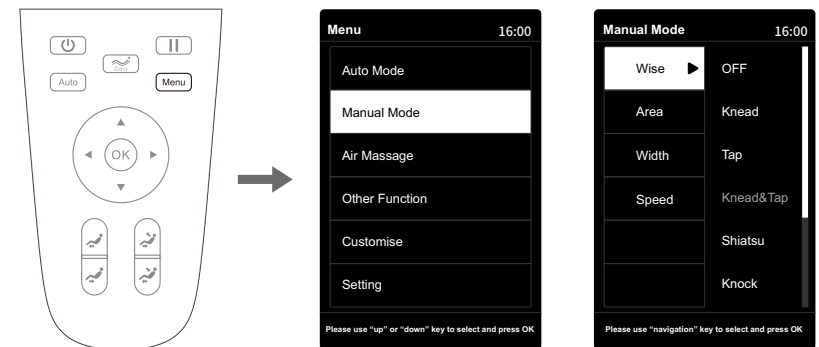

Method of Usage

01).Manual program - method

- Method: including 7 different massage methods such as kneading, tapping, kneading and Tapping, shiatsu, knocking and 3D (3D I and 3D II). The width of the manipulator massage ball can be adjusted under the massage methods including tapping, shiatsu, knocking and 3D II. Except for stopping, the massage speed can be adjusted under other massage methods.
- After entering the manual program interface, press the "Up" or "Down" key to select the message method function, enter the message method sub-menu using the "Right" key to select, then press the "Up" or "Down" key to select any message method, and press the "OK" key to confirm; press the "Left" key to return to the previous menu interface.

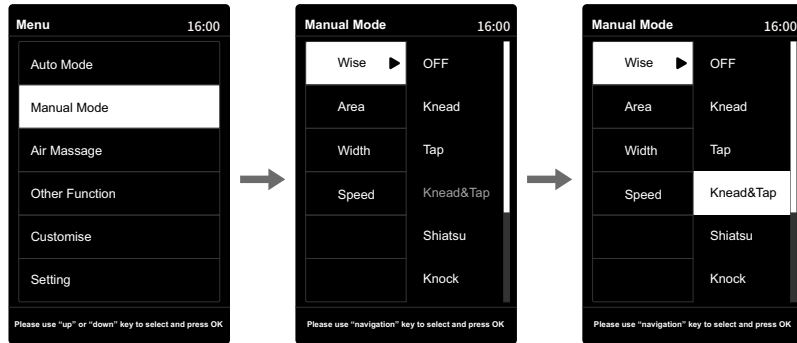

Function	Massage ball adjustment	
OFF	Width.	Adjustable speed in three gears Adjustable width in three gears
Knead	Speed.	
Tap	Speed and width.	
Knead&Tap	Speed	
Shiatsu	Width.	
Knock	Speed and width.	
3D I	Speed.	
3D II	Speed and width.	

Method of Usage

02).Manual program - position

- Position: including fixed point, local, upper body, lower body and whole body.
- After entering the manual program interface, press the "Up" or "Down" key to select the message position function, enter the message position function sub-menu using the "Right" key to select, then press the "Up" or "Down" key to select any message position, and press the "OK" key to confirm; press the "Left" key to return to the previous menu interface.

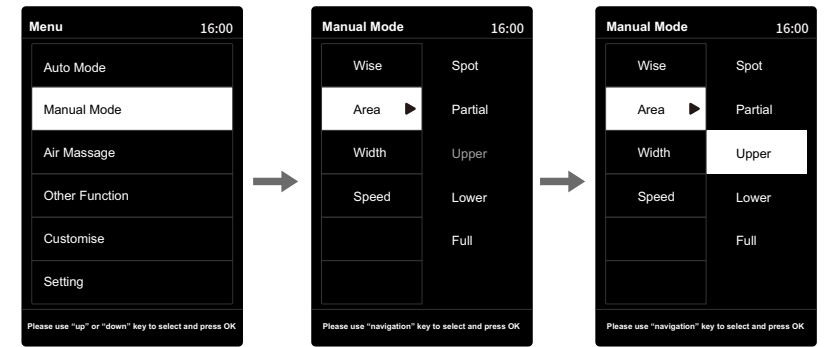

Function	Description	
Spot	Fixed-point massage at fixed-point position.	When selecting fixed-point and local massage methods, the massage area can be adjusted using the "Up" or "Down" key in the information interface.
Partial	Small-scope local massage back and forth.	
Upper	Upper back massage back and forth.	
Lower	Lower back massage back and forth.	
Full	Full back massage back and forth.	

Method of Usage

03).Manual program - width

- Width: Manipulator massage width adjustment, with a total of 3 gears.
- Enter the manual program interface, press the "Up" or "Down" key to select the width function, enter the width function sub-menu using the "Right" key to select, then press "Up" key or "Down" key to select any massage width, and press the "OK" key to confirm; press the "Left" key to return to the previous menu interface.

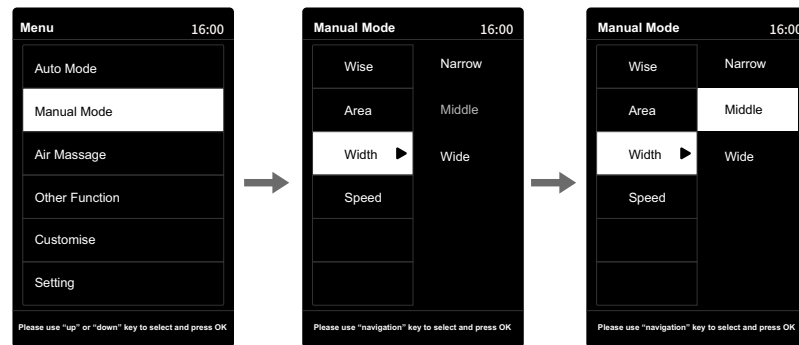

Note:

Width: the width can be adjusted under the massage methods including slapping, finger pressing , tapping and 3D II, with a total of 3 gears.

04).Manual program - speed

- Speed: Manipulator massage speed adjustment, with a total of 3 gears.
- Enter the manual program interface, press the "Up" or "Down" key to select the speed, enter the speed function sub-menu using the "Right" key to select, then press the "Up" or "Down" key to select any massage speed, and press the "OK" key to confirm. Press the "Left" key to return to the previous menu interface.

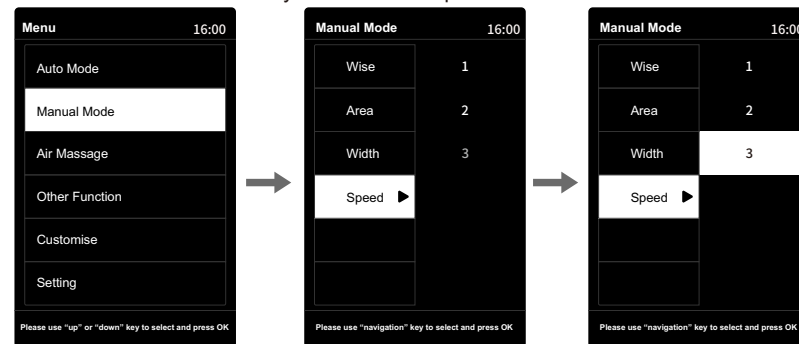

Method of Usage

3).Air compression massage (menu - air compression massage)

- Press the "Menu" key to enter the menu interface, press the "Up" or "Down" key to select air compression massage, and press the "OK" key to enter the air compression massage interface.
- Air compression massage: including upper body air compression, lower body air compression, air compression intensity and other massage functions.
- After entering the air compression massage interface, press the "Up" or "Down" key to select any air compression function, then select the sub-menu of this function using the "Right" key, and then press the "OK" key to confirm. Press the "Left" key to return to the previous menu interface.

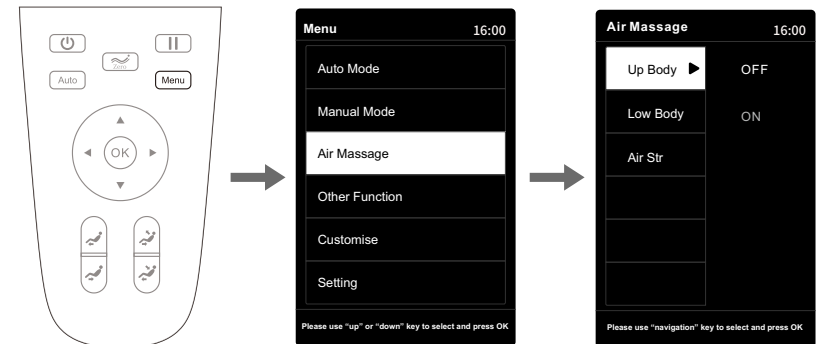

01).Air compression massage - upper body air compression

- Upper body air compression: including plam air pressure, arm air pressure, shoulder air pressure, and other air compression massage functions.
- Enter the air compression massage interface, press the "Up" or "Down" key to select the upper body air compression massage function, enter the upper body air compression sub-menu using the "Right" key to select, then press the "Up" or "Down" key to select to turn on or off the upper body air compression function, and press the "OK" key to confirm. Press the "Left" key to return to the previous menu interface.

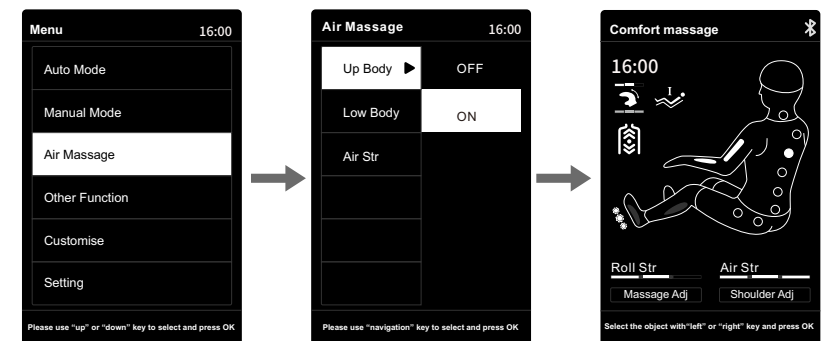

Method of Usage

02).Air compression massage - lower body air compression

- Lower body air compression: including leg air compression, foot air compression and other air compression massage functions.
- Enter the air compression massage interface, press the "Up" or "Down" key to select the air compression intensity, enter the air compression intensity sub-menu using the "Right" key to select, then press the "Up" or "Down" key to select any air compression intensity gear, and press the "OK" key to confirm. Press the "Left" key to return to the previous menu interface.

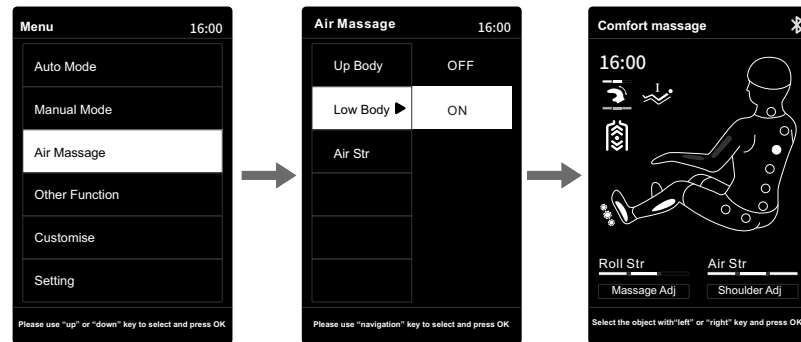

03).Air compression massage - air compression intensity

- Air compression intensity: the intensity can be adjusted in three gears.
- Enter the air compression massage interface, press the "Up" or "Down" key to select the air compression intensity, enter the air compression intensity sub-menu using the "Right" key to select, then press the "Up" or "Down" key to select any air compression intensity gear, and press the "OK" key to confirm. Press the "Left" key to return to the previous menu interface.

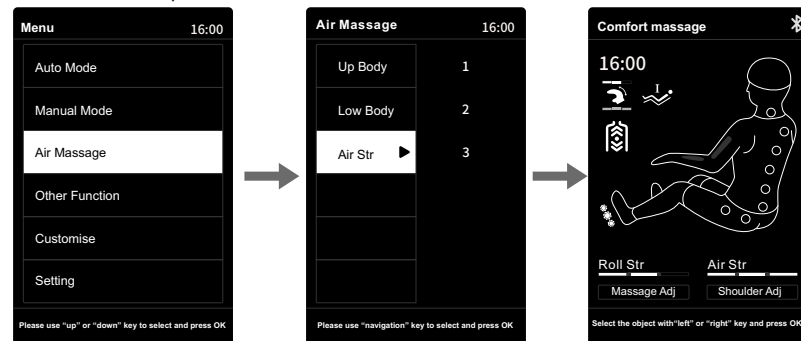

Method of Usage

4).Other function (menu - other function)

- Press the "Menu" key to enter the menu interface, press the "Up" or "Down" key to select other functions, and press the "OK" key to enter the other function interface.
- Other functions: Include Foot roller, back heating and calfrest heating.
- Enter the other function interface, press the "Up" or "Down" key to select one type of function, enter the other function sub-menu using the "Right" key to select, then press the "OK" key to confirm. Press the "Left" key to return to the previous menu interface.

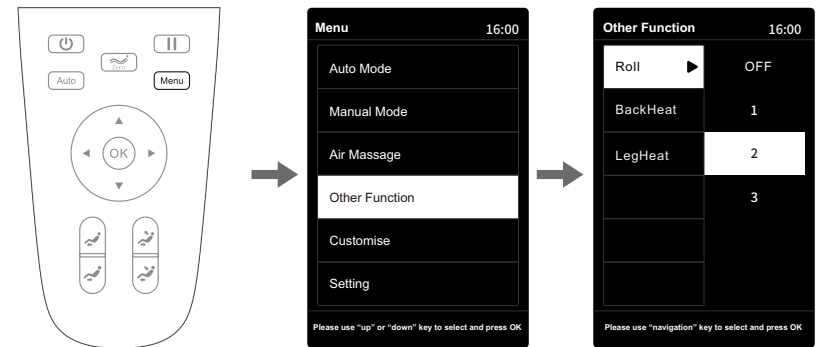

01).Other function-foot roller function

- Foot roller: with four modes: OFF/Gear 1/Gear 2/Gear 3, The default mode is Gear 2.
- After entering the interface of other functions, press "up" or "down" to select the foot roller massage function, enter the sub-menu of the foot roller by "right" to select, and then press "up" or "down" to select any type of roller strength and switch, and press "OK" to confirm. Press the "left" to return to the menu interface of the previous level.

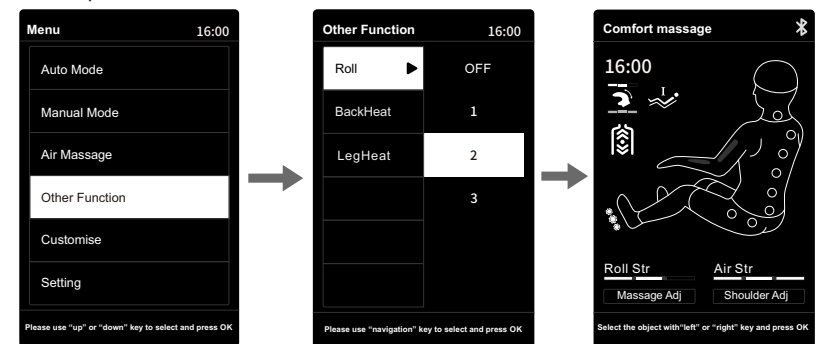

Method of Usage

02).Other function--back heating function

- Back heating function: You will feel warm after start heating function 3 mins.
- When you enter the auxiliary function interface, press "upper" or "lower" button to choose the back heating function. Through "right" button enter to the submenu, then choose "upper" or "lower" button to turn on or off, press "ok" to confirm. Press "left" button to back to the previous menu.

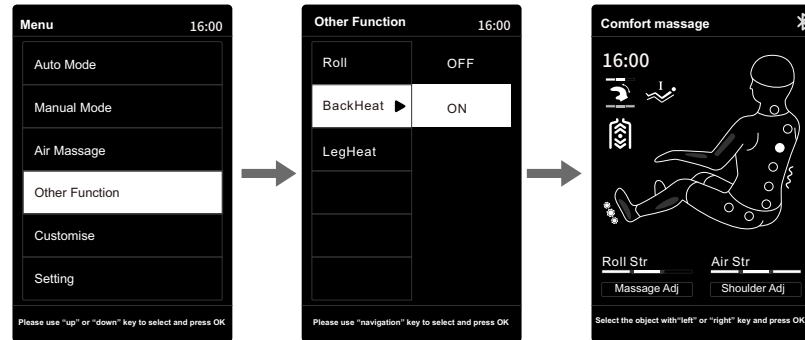

03).Other function--calfrest heating function

- Calfrest heating function: You will feel warm after start heating function 3 mins.
- When you enter the auxiliary function interface, press "upper" or "lower" button to choose the calfrest heating function. Through "right" button enter to the submenu, then choose "upper" or "lower" button to turn on or off, press "ok" to confirm. Press "left" button to back to the previous menu.

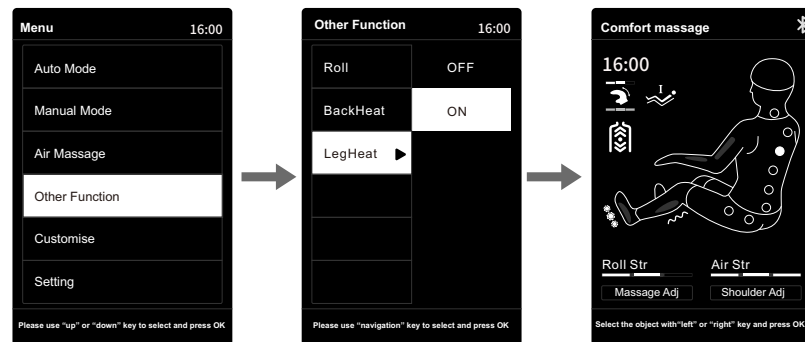

Method of Usage

5).Memory storage (menu - memory storage)

- Press the "Menu" key to enter the menu interface, press the "Up" or "Down" key to select the memory storage function, and press the "OK" key to enter the memory storage interface, including storage functions such as storage call and storage save.
- Memory storage includes three functions: storage 1, storage 2 and storage 3.
- After entering the memory storage interface, press the "Up" or "Down" key to select any of storage 1, storage 2 and storage 3, enter the storage or call sub-menu using the "Right" key, then press the "Up" or "Down" key to select, and press the "OK" key to confirm. Press the "Left" key to return to the previous menu interface.
- Storage: Storing the currently running message program, including message method, air compression mode and intensity, position and angle of lower leg frame and backrest frame, and other message functions.
- Call: Calling the previously saved message program, including message mode, message method, air compression mode and strength, position and angle of lower leg frame and backrest frame, and other message functions.

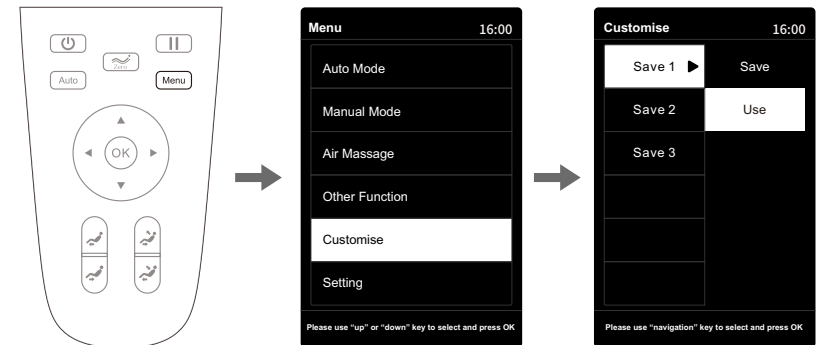

6).Setting function (menu - setting function)

- Press the "Menu" key to enter the menu interface, press the "Up" or "Down" key to select the setting function, and press the "OK" key to enter the setting function interface.
- Setting functions: including Bluetooth, voice control, language, serial number and other setting functions.
- After entering the setting function interface, press the "Up" or "Down" key to select any setting function, then select the sub-menu of this function using the "Right" key, and then press the "OK" key to confirm. Press the "Left" key to return to the previous menu interface.

Method of Usage

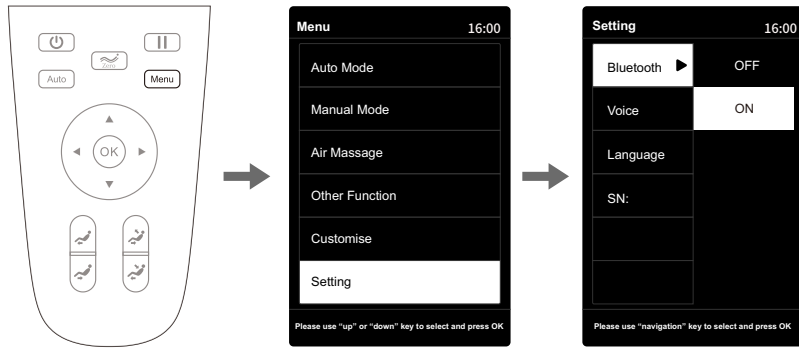

01).Setting function - Bluetooth

- Bluetooth: Turn on the Bluetooth function of the massage chair to connect the sound source device with Bluetooth function (such as mobile phone, MID tablet, etc.). After pairing and connecting with the Bluetooth module of the massage chair, the music played by the sound source device can be wirelessly transmitted to the sound system of the massage chair through Bluetooth for music playing.
- After entering the setting function interface, press the "Up" or "Down" key to select the Bluetooth function, enter the Bluetooth function sub-menu using the "Right" key to select, then press the "Up" or "Down" key to select to turn on or off the Bluetooth function, and press the "OK" key to confirm; press the "Left" key to return to the previous menu interface.

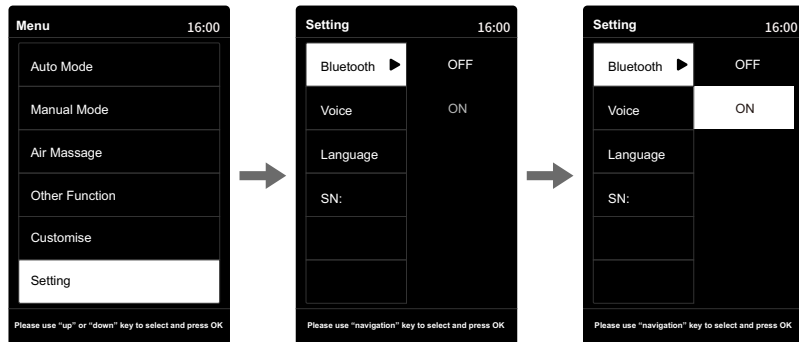

Method of Usage

02).Setting function - voice control

- Voice control: intelligent voice control function (this function has memory, i.e. if selected, it is still the function selected when the product is restart after power failure); Note: When the intelligent voice control is turned off, voice wake-up cannot be performed.
- After entering the setting function interface, press the "Up" or "Down" key to select the voice control function, enter the voice control function sub-menu using the "Right" key to select, then press the "Up" or "Down" key to select to turn on or off the voice control function, and press the "OK" key to confirm; press the "Left" key to return to the previous menu interface.

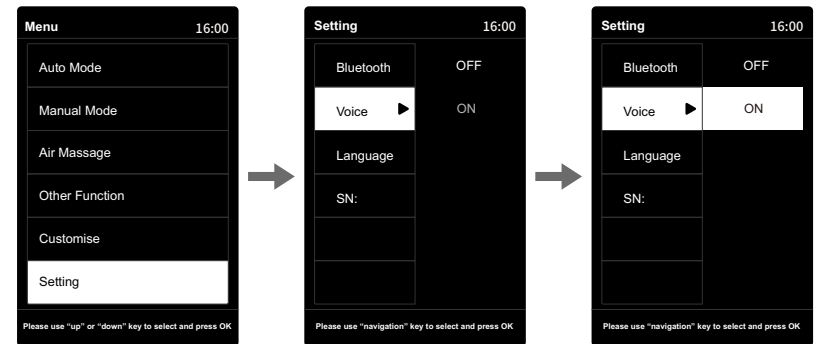

03).Setting function - language

- Language: including Simplified Chinese and English.
- After entering the setting function interface, press the "Up" or "Down" key to select the language function, enter the language function sub-menu using the "Right" key to select, then press the "Up" or "Down" key to select any language function, and then press the "OK" key to confirm; press the "Left" key to return to the previous menu interface.



Method of Usage

04).Setting function - serial number

- Serial number: displaying current device information
- After entering the setting function interface, press the "Up" or "Down" key to select the serial number, and press the "Left" key to return to the previous menu interface.

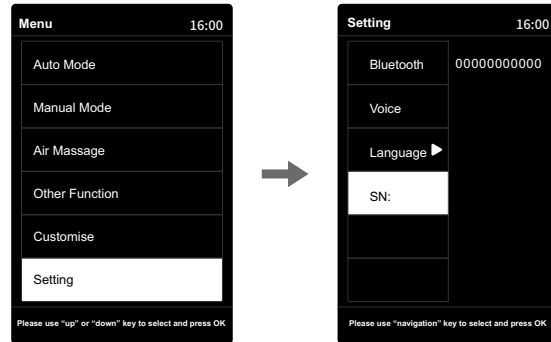

7).Massage adjustment

- In the information interface, press the "Left" or "Right" key to select the massage adjustment button, and press the "OK" key to enter the massage adjustment interface.
- Massage adjustment includes three massage adjustment functions for selection, i.e. 3D intensity, air compression intensity and time adjustment.
- After entering the massage adjustment interface, press the "Up" or "Down" key to select any massage adjustment function, then enter the massage adjustment sub-menu using the "Right" key to select, then press the "Up" or "Down" key to select the desired massage adjustment gear, and press the "OK" key to confirm. Press the "Left" key to return to the previous menu interface.

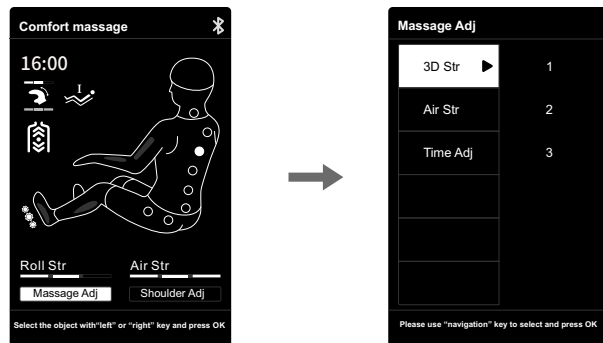

Method of Usage

Function	Description
3D Str	Neck, back, waist, hip massage intensity adjustment, with a total of 3 gears.
Air Str	The strength can be adjusted in 3 gears.
Time Adj	4 modes are available, i.e. +10 minutes, +5 minutes, -5 minutes and -10 minutes.

Note:

- Depending on the remaining massage time, when the displayed time is not enough to add or subtract a certain time, the operation will not be displayed (the upper limit of time display is 40 minutes). For example, if the displayed time of the manual controller is 39 minutes, the adjustment range of massage time is -5 minutes or -10 minutes (+10 minutes and +5 minutes cannot be displayed).
- Among them, the adjustment of air compression intensity can only be used when the air compression function or the automatic function is turned on (please refer to page 21 of this manual for details on the mode for turning on the air compression function).

5.Zero-gravity key



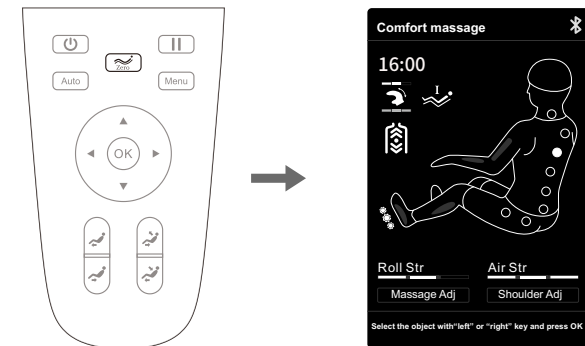

- Zero-gravity key: each time the key is pressed, the position of the lower leg frame and backrest frame will be automatically adjusted to the zero-gravity position, with a total of three zero-gravity lying modes in cyclic switching.



Function	Description
	Zero-gravity key: each time the key is pressed, the position of the lower leg frame and backrest frame will be automatically adjusted to the zero-gravity position, with a total of three zero-gravity lying modes in cyclic switching.

Method of Usage

6. Lying angle adjustment key

Function	Description
	Lower leg frame ascending key: press and hold this key to slowly rise the lower leg frame, and release it to stop rising.
	Lower leg frame descending key: press and hold this key to slowly lower the lower leg frame, and release it to stop lowering.
	Linkage sit-up key: press and hold this key to slowly rise the backrest frame while slowly lowering the lower leg frame, and release it to stop rising of the backrest frame or lowering of the lower leg frame.
	Linkage lying key: press and hold this key to slowly lower the backrest frame while slowly rising the lower leg frame, and release it to stop lowering of the backrest frame or rising of the lower leg frame.





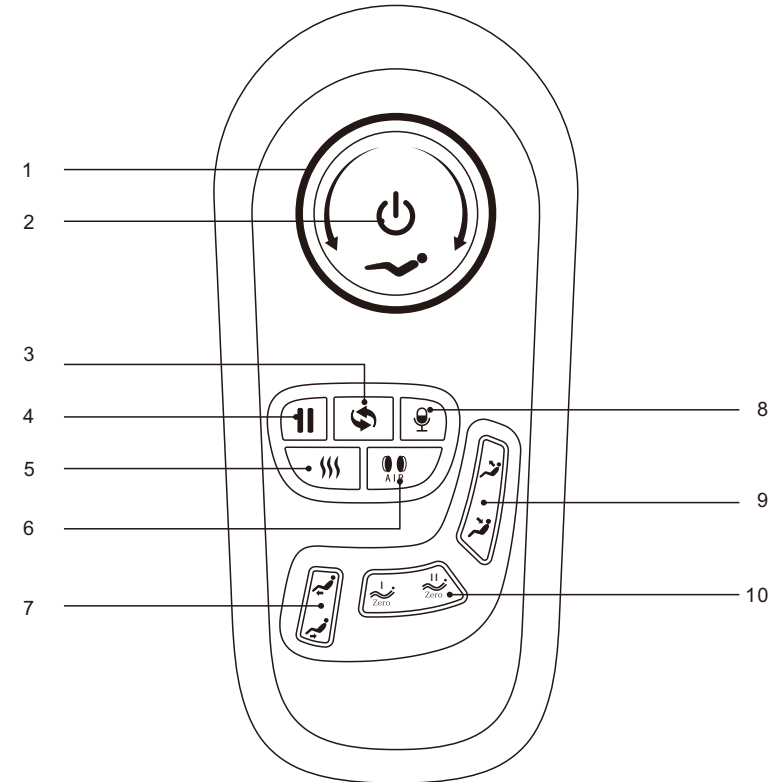









Method of Usage

III. Introduction to Armrest Shortcut Keys



1. Linkage adjustment key: Press it to perform linkage adjustment on the backrest for upward/downward movement.
2. ON/OFF key: Press it to start the massage chair.
3. AUTO key: Press it to enable the automatic massage function.
4. Pause/run button: Pause or run all massage functions.
5. Heat treatment key: Click the key to enable or disable the heat treatment function.
6. Air pressure key: Turn on/off air pressure massage function.
7. Legrest up/down key: Press it to make the legrest move upward/downward.
8. Voice control and wake-up button: Short press to enable the voice control function, long press 3 seconds to turn on or off the voice control function.
9. Backrest up/down key: Press it to make the backrest move upward/downward.
10. Zero-gravity key: Press it to adjust the massage chair to the angle for zero gravity.

Method of Usage

Function	Description
	USB jack: USB charging port, you can charge smart devices (such as mobile phones). Open key: short press this key to open key.
	Power button: Short press this button to turn ON/OFF the massage.
	Linkage lying knob: By rotating this knob clockwise, the backrest will move downward slowly and the legrest will rise slowly; by releasing it, such DOWN/UP action of the backrest and the legrest will be stopped.
	Linkage sitting knob: By rotating this knob counterclockwise, the backrest will rise slowly and the legrest will move downward slowly; by releasing it, such UP/DOWN action of the backrest and the legrest will be stopped.
	Press this button during massage, and all the massage actions will be suspended at once. (i.e. the massage chair will turn off after 20min). Then press this button again to restore all the previous massage actions.
	Automatic mode key: Press it to switch among those automatic massage functions.
	Voice control and wake-up button: Short press to enable the voice control function, long press 3 seconds to turn on or off the voice control function.
	Heat treatment key: Click the key to enable or disable the heat treatment function.
	AIR Air pressure key: Turn on/off air pressure massage function.
	Legrest up button: Pull the button to make the legrest rise slowly. Release it to stop such action.
	Legrest down button: Press the button to make the legrest move downward slowly. Release it to stop such action.
	Zero-gravity key I : the positions of the legrest and the backrest can be automatically adjusted to the positions I for zero gravity.
	Zero-gravity key II : the positions of the legrest and the backrest can be automatically adjusted to the positions II for zero gravity.
	Backrest up button: the back rest keeping lifting when pressing this button, and black rest stopped lifting once release the button.
	Backrest down button: the back rest keeping reclining when pressing this button, and black rest stopped reclining once release the button.

Method of Usage

IV.Voice Control Instruction

- When the massage chair is turned on or in standby mode, the sound “Hi Alice” or “Hey Alice” will be produced to enable the voice control function. Alternatively, you can press the voice control button on the armrest to enable the voice control function.
- Long press the Voice control button 3 seconds to turn on or off the voice control function.
- After such function is enabled successfully, the massage chair will reply “I am here” At this moment, once a corresponding voice control entry to be implemented is given within six seconds, the corresponding voice control function can be performed after a reply is received from the massage chair; if no correct voice control entry is given within six seconds, the voice control function automatically will be off automatically and needs to be enabled again.
- Note: When waking up the voice control function, please use English, the speech rate is moderate, Voice commands should be follow up the Voice entry.

Voice Control Entry		
Entry: “Hi Alice” or “Hey Alice”. Answer: I am here.		
No.	Voice control entry	Answer entry
1	Massage on	Answer: Ok, massage on
2	Massage close	Answer: Ok, massage close
3	Comfort Massage	Answer: Ok, comfort massage
4	Relax massage	Answer: Ok, relax massage
5	Full body massage	Answer: Ok, full body massage
6	Neck and shoulder massage	Answer: Ok, neck and shoulder massage
7	Back and waist massage	Answer: Ok, back and waist massage
8	Stretch massage	Answer: Ok, stretch massage
9	Open the air pressure	Answer: Ok, open the air pressure
10	Close the air pressure	Answer: Ok, close the air pressure
11	Up the seat position	Answer: Ok, up the seat position
12	Down the seat position	Answer: Ok, down the seat position
13	Change the other mode	Answer: Ok, change the other mode
14	Go little down	Answer: Ok, go little down
15	Go little up	Answer: Ok, go little up

Note: commands 14 and 15 can only be used after command 13.

Method of Usage

V. Turn off power and stop massage

- During the massage process, press the power switch key to immediately turn off all massage functions, the seat back and the foot pad are reset, the massage time is up, and all massage functions are immediately turned off, and the seat back and the foot pad are not reset.
- Cut off the power supply of the whole machine, the figure (schematic diagram of the whole machine power cut).

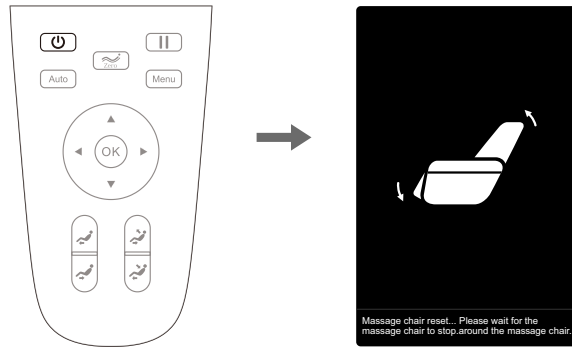

- Cut off the power supply of the whole machine, the figure (schematic diagram of the whole machine power cut).

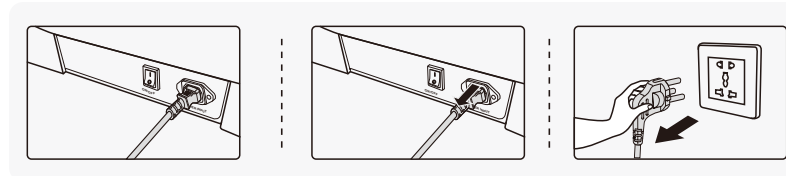

- ❶ Schematic diagram of the whole machine power turning off.
- ❷ Schematic diagram of unplugging the whole machine wiring.
- ❸ Schematic diagram of unplugging the power plug.

VI. Operation Instructions for Bluetooth Speaker Play

1. Enter the smart device manual and open the Bluetooth function to search the new Bluetooth devices.
2. Will find the bluetooth named like (IMCM-XXXX), choose it to pair with the chair .
3. Turn on the Music Player in the smart device.

Method of Usage

VII. Installation Instructions for Legrest

- After connecting the wires and the air hose between the legrest and the massage chair, remove the cable ties and insert the connecting part into the seat (Figure 1).
- Place the round tubes on the left and right sides of the legrest onto the legrest support (Figure 2).

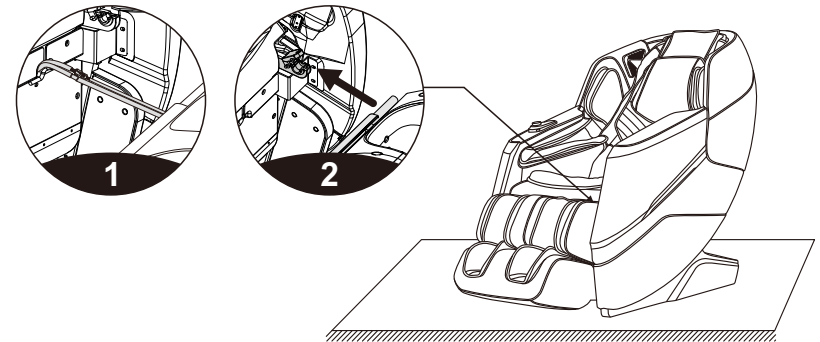

- Next, turn the legrest fixing cover over to cover the round tubes on both sides of the legrest (Figure 3).
- Fasten the legrest to the massage chair with two M4 screws (one on each side). Check whether there is any abnormality during turning up and down, or any tube, cable or wire is folded. If everything is OK, the legrest is installed (Figure 4).

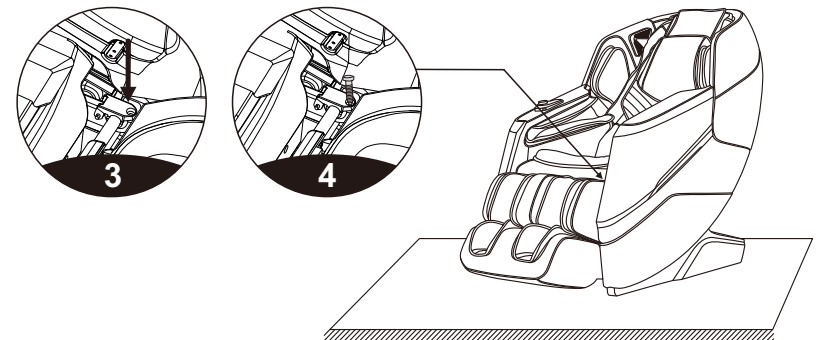

Method of Usage

VIII. Instructions for removal and use of head cushion and backrest

- The use of the head cushion can reduce the intensity of kneading massage on the neck and shoulders. You can decide whether to use the head cushion according to your own needs (the head cushion is recommended). The backrest and the back cushion are connected by a zipper (1). The head cushion and the backrest are connected by a zipper (2).

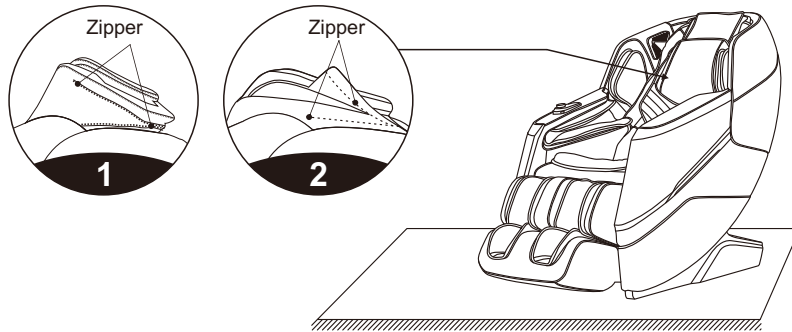

IX. Floor Protection

- The prolonged heavy pressure on the massage chair may cause scratches on the floor. Thus, put a carpet or cushion on the floor where the massage chair is placed to avoid this damage.

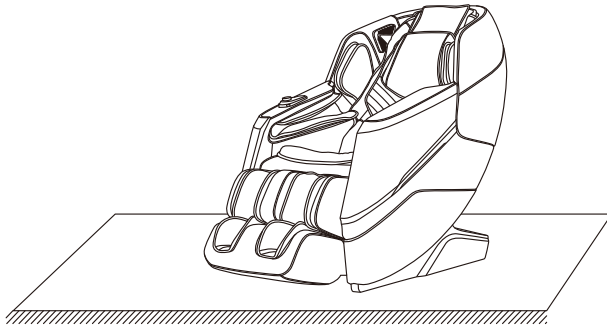

Note: Do not move the massage chair with its wheels on the rough ground or in a narrow space. At least two persons are required to lift it. During lifting, take the legrest sealing plate and backrest cover grooves as the acting points. (Do not lift the armrest directly.)

Method of Usage

X. Instruction for movement

- Make sure that all the wires are pulled away from the massage chair surface; then press the backrest down to a certain angle (with the center of gravity resting on the wheels), you can push the massage chair forward with hands, move it to a suitable position and gently restore it to the normal angle. (Note: During movement, you must turn off the power button first and then unplug the power cord and the remote controller connection wire.)

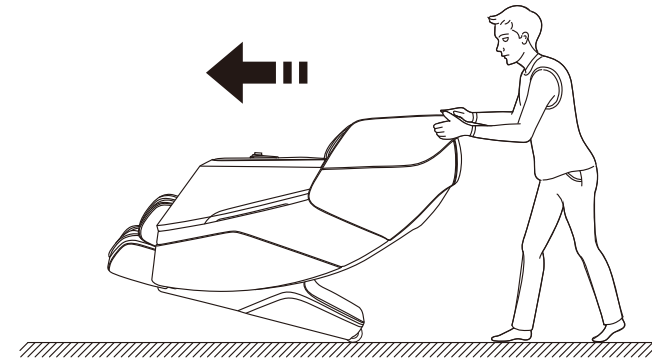

Warning : The rear moving wheels of the massage chair are only suitable for short-distance and slow movement. For long-distance transportation, please use other auxiliary moving tools to move this massage chair!

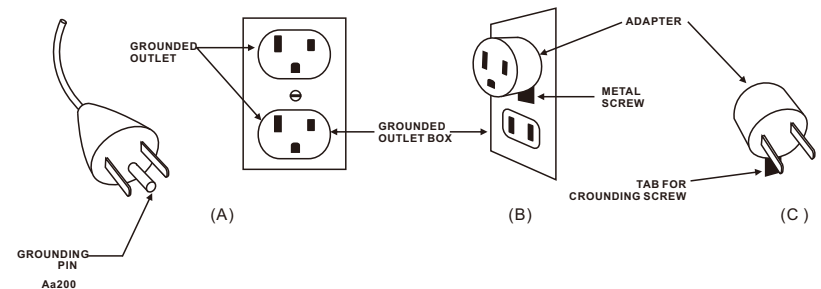

Product Specification

Model: OS- Tao 3D

Name: Massage Chair

Rated voltage: 110-120V~ 60Hz
220-240V~ 50Hz/60Hz

Rated power:120W

Rated time: 20min

Safety structure: Class I

Material description: PVC, PA, steel parts, electric and electron components

MATERIAL	PU	LEATHER	CLOTH	WOOD